

# REX

## THREE PASS REVERSE FLAME

- high water content
- flanged front plate
- wet back



Model	Boiler Code	Output	Input	Efficiency		Pressure Drop	Burner blast tube length	Burner hole Ø	Water side pressure drop	Water volume	Dimensions	Weight	Ø C
		kw	kw	100%	30%								
REX 7	83801010	70	76	92,11	90,18	0,8	200-250	130	9	105	1030 x 750 x 994	216	200
REX 8	83801020	80	87	91,95	90,23	1,0	200-250	130	9	105	1030 x 750 x 994	216	200
REX 9	83802010	90	98	91,84	90,30	0,8	200-250	130	10	123	1030 x 750 x 1119	258	200
REX 10	83802020	100	109	91,74	90,40	1,0	200-250	130	12	123	1030 x 750 x 1119	258	200
REX 12	83802030	120	131	91,60	90,45	1,1	200-250	130	13	123	1030 x 750 x 1119	258	200
REX 15	83803010	150	163	92,02	91,15	1,2	200-250	160	14	172	1080 x 800 x 1364	346	250
REX 20	83803020	200	218	91,74	91,36	1,9	200-250	160	15	172	1080 x 800 x 1364	346	250
REX 25	83804010	250	272	91,91	90,40	2,0	200-250	160	15	220	1080 x 800 x 1614	431	250
REX 30	83805010	300	325	92,31	90,62	2,0	200-250	180	16	300	1180 x 900 x 1614	475	250
REX 35	83806010	350	380	92,11	90,50	2,9	200-250	180	18	356	1180 x 900 x 1864	542	250
REX 40	83807010	400	433	92,38	90,81	4,1	230-280	225	20	360	1190 x 940 x 1872	584	250
REX 50	83808010	500	542	92,25	90,71	4,2	270-320	225	22	540	1380 x 1160 x 1946	853	300
REX 62	83809010	620	672	92,26	90,68	6,4	270-320	225	27	645	1380 x 1160 x 2235	963	300
REX 75	83810010	750	813	92,25	90,60	5,2	270-320	280	25	855	1510 x 1290 x 2247	1205	350
REX 85	83810020	850	921	92,29	90,73	7,2	270-320	280	27	855	1510 x 1290 x 2247	1205	350
REX 95	83811010	950	1030	92,23	90,70	5,2	270-320	280	32	950	1510 x 1290 x 2497	1417	350
REX 100	83812010	1020	1106	92,22	90,65	4,0	270-320	280	26	1200	1660 x 1440 x 2477	1843	400
REX 120	83812020	1200	1301	92,24	90,67	5,5	270-320	280	30	1200	1660 x 1440 x 2477	1843	400
REX 130	83812030	1300	1409	92,26	90,61	6,5	270-320	280	32	1200	1660 x 1440 x 2477	1843	400

Working pressure: 5bar

Fuel: natural gas, gpl, light oil

Minimal return water temperature: 50C°

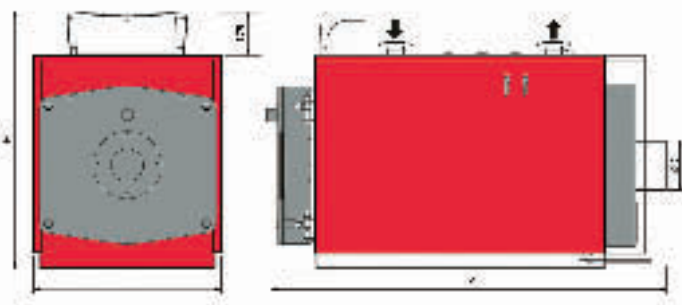

### Standard equipment

- Outer casing with high density insulation
- Turbulators
- Cleaning tool
- Control panel complete with:
  - 1 main switch
  - 2 boiler control thermostats
  - 1 safety limit thermostat - manual reset
  - 1 pump thermostat
  - 1 burner on/off switch
  - 1 pump on/off switch
  - 1 boiler thermometer

Optional	Code	For details see
Control panel with digital controller RVA 43 for on/off and high/low burners *	QCLI4301	Page 38
Control panel with digital controller RVA 63 for modulating burners *	QCLI6301	Page 38
Calorifier sensor for controllers RVA	17120078	Page 38
Volt free kit	KITDO01	Page 40
Super insulation	Depends on model	Page 40

EFFICIENCY



# REX

## THREE PASS REVERSE FLAME

- high water content
- flanged front plate
- wet back
- lagged and clad with circular stucco aluminium casing fitted at the factory



Model	Boiler Code	Output Input		Efficiency		Pressure Drop	Burner blast tube length	Burner hole Ø	Water side pressure drop	Water volume	Dimensions (H x L x P in mm)	Weight	Ø C
		kw	kw	100%	30%								
REX 140	83813010	1400	1517	92,29	90,36	6,0	350-400	320	28	1500	1746 x 1470 x 2886	2600	400
REX 160	83813020	1600	1733	92,33	90,41	6,5	350-400	320	32	1500	1746 x 1470 x 2886	2600	400
REX 180	83814010	1800	1950	92,31	90,50	7,0	450-500	320	37	1650	1746 x 1470 x 3096	2750	400
REX 200	83815010	2000	2167	92,29	90,30	6,0	450-500	360	35	2000	1876 x 1600 x 3220	3650	500
REX 240	83816010	2400	2600	92,31	90,60	7,5	450-500	360	40	2300	1876 x 1600 x 3480	3900	500
REX 300	83817010	3000	3250	92,31	90,55	8,0	450-500	400	49	3150	2146 x 1870 x 3480	5200	550
REX 350	83818010	3500	3792	92,30	90,20	9,0	450-500	400	60	3650	2146 x 1870 x 3935	5700	550

Working pressure: 5 bar

Fuel: natural gas, gpl, light oil

Minimal return water temperature: 50C°

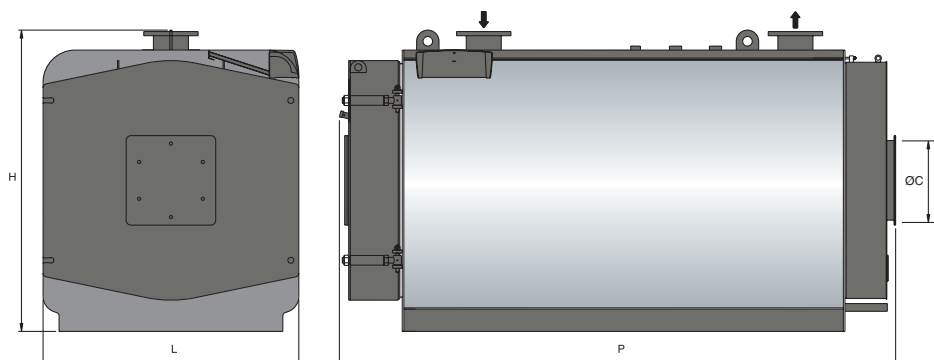

### Standard equipment

- Outer casing with high density insulation
- Turbulators
- Cleaning tool
- Control panel complete with:
  - 1 main switch
  - 2 boiler control thermostats
  - 1 safety limit thermostat - manual reset
  - 1 pump thermostat
  - 1 burner on/off switch
  - 1 pump on/off switch
  - 1 boiler thermometer

Optional	Code	For details see
Control panel with digital controller RVA 43 for on/off and high/low burners *	QCLI4301	Page 38
Control panel with digital controller RVA 63 for modulating burners *	QCLI6301	Page 38
Calorifier sensor for controllers RVA	17120078	Page 38
Volt free kit	KITDO01	Page 40

# REX K / KF

## UNASSEMBLED KIT FORM

Prepared for site welding, REX K / KF boilers are designed for installation in boiler rooms where no access has been provided for pre-assembled boilers.

- assembly and welding are not included in the boiler selling price
- pressure test, up to the customer, made at the end of the assembly
- the single pieces are available on pallets with the assembly instructions

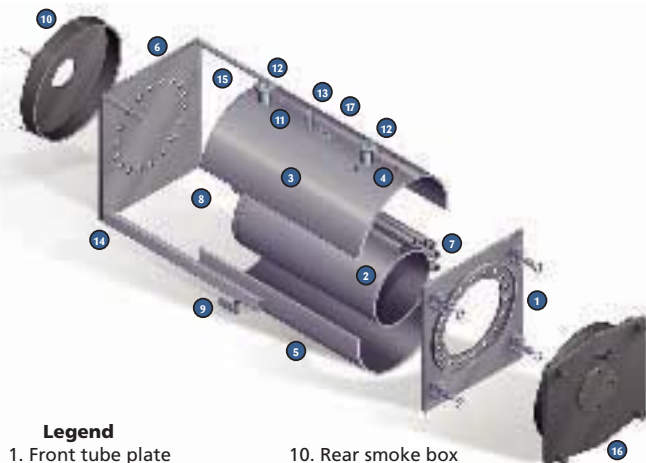

### Legend

- |                       |                               |
|-----------------------|-------------------------------|
| 1. Front tube plate   | 10. Rear smoke box            |
| 2. Furnace            | 11. Thermostats pockets       |
| 3. Upper boiler shell | 12. Flow and return           |
| 4. Return trap        | 13. Safety valves connections |
| 5. Lower boiler shell | 14. Boiler frame              |
| 6. Rear tube plate    | 15. Upper frame support       |
| 7. Smoke tubes        | 16. Boiler door               |
| 8. Rear stay support  | 17. Eyebolt                   |
| 9. Boiler drain       |                               |

Model	Boiler Code	Output	Input	Efficiency	Pressure Drop	Burner blast tube length	Burner hole Ø	Water side pressure drop	Water volume	Dimensions	Weight	Ø C
		kw	kw	100% 30%	mbar	mm	mm	(ΔT=12°C) mbar	l	(H x L x P in mm)	kg	mm
REX K 15	83803050	150	163	92,02 91,15	1,2	200-250	160,0	14	172	1080 x 800 x 1440	346	250
REX K 20	83803060	200	218	91,74 91,36	1,9	200-250	160,0	15	172	1080 x 800 x 1440	346	250
REX K 25	83804020	250	272	91,91 90,40	2,0	200-250	160,0	15,0	220,0	1080 x 800 x 1690	431	250
REX K 30	83805020	300	325	92,31 90,62	2,0	200-250	180,0	16,0	300,0	1180 x 900 x 1690	475	250
REX K 35	83806020	350	380	92,11 90,64	2,9	200-250	180,0	18,0	356,0	1180 x 900 x 1940	542	250
REX K 40	83807020	400	433	92,38 90,81	4,1	230-280	225,0	20,0	360,0	1190 x 940 x 1900	584	250
REX K 50	83808020	500	542	92,25 90,71	4,2	270-320	225,0	22,0	540,0	1380 x 1160 x 1950	853	300
REX K 62	83809020	620	672	92,26 90,68	6,4	270-320	225,0	27,0	645,0	1380 x 1160 x 2240	963	300
REX K 75	83810030	750	813	92,25 90,60	5,2	270-320	280,0	25,0	855,0	1510 x 1290 x 2255	1205	350
REX K 85	83810040	850	921	92,29 90,73	7,2	270-320	280,0	27,0	855,0	1510 x 1290 x 2255	1205	350
REX K 95	83811020	950	1030	92,23 90,70	5,2	270-320	280,0	32,0	950,0	1510 x 1290 x 2500	1417	350
REX K 100	83812040	1020	1106	92,22 90,65	4,0	270-320	280,0	26,0	1200,0	1660 x 1440 x 2500	1843	400
REX K 120	83812050	1200	1301	92,24 90,67	5,5	270-320	280,0	30,0	1200,0	1660 x 1440 x 2500	1843	400
REX K 130	83812060	1300	1409	92,26 90,61	6,5	270-320	280,0	32,0	1200,0	1660 x 1440 x 2500	1843	400
REX K 140	83813040	1400	1517	92,29 90,36	6,0	350-400	320,0	28,0	1500,0	1660 x 1440 x 2500	2600	400
REX K 160	83813050	1600	1733	92,33 90,41	6,5	350-400	320,0	32,0	1500,0	1660 x 1440 x 2500	2600	400
REX K 180	83814050	1800	1950	92,31 90,50	7,0	450-500	320,0	37,0	1650,0	1660 x 1440 x 2500	2750	400

Working pressure: 5 bar

Fuel: natural gas, gpl, light oil

Minimal return water temperature: 50C°

### Standard equipment

- Outer casing with high density insulation
- Turbolators
- Cleaning tool
- Control panel complete with:
  - 1 main switch
  - 2 boiler control thermostats
  - 1 safety limit thermostat - manual reset
  - 1 pump thermostat
  - 1 burner on/off switch
  - 1 pump on/off switch
  - 1 boiler thermometer

Optional	Code	For details see
Control panel with digital controller RVA 43 for on/off and high/low burners *	QCLI4301	Page 38
Control panel with digital controller RVA 63 for modulating burners *	QCLI6301	Page 38
Calorifier sensor for controllers RVA	17120078	Page 38
Volt free kit	KITDO01	Page 40
Super insulation	Depends on model	Page 40



# REX DUAL / DUAL F

## THREE PASS REVERSE FLAME DOUBLE FURNACE

Two equal capacity stacked modules, connected with flow and return headers housed in the back of the boiler.

- insulation coating of thick rock wool boards and painted steel sheets for two modules to reduce the external surface area and radiation loss
- digital sequencer (optional) mounted inside the REX DUAL / DUAL F control panel, allows intelligent management of the two high/low burners, increasing the boiler efficiency
- divides the thermal load into equal parts between the two modules
- set temperature is reached gradually so that burner cycling is avoided

Model	Boiler Code	Output	Input	Efficiency	Pressure Drop	Burner blast tube length	Burner hole Ø	Water side pressure drop	Water volume	Dimensions	Weight	Ø C
		kw	kw	100% 30%	mbar	mm	mm	(ΔT=12°C) mbar	l	(H x L x P in mm)	kg	mm
REX DUAL 14	83801030	70	76	92,11 90,18	0,8	200-250	130	9	105	1693 x 930 x 1365	410	200
REX DUAL 16	83801040	80	87	91,95 90,23	1,0	200-250	130	9	105	1693 x 930 x 1365	410	200
REX DUAL 18	83802040	90	98	91,84 90,30	0,8	200-250	130	10	123	1693 x 930 x 1490	500	200
REX DUAL 20	83802050	100	109	91,74 90,40	1,0	200-250	130	12	123	1693 x 930 x 1490	500	200
REX DUAL 24	83802060	120	131	91,60 90,45	1,1	200-250	130	13	123	1693 x 930 x 1490	500	200
REX DUAL 30	83803030	150	163	92,02 91,15	1,2	200-250	160	14	172	1793 x 980 x 1798	725	250
REX DUAL 40	83803040	200	218	91,74 91,36	1,9	200-250	160	15	172	1793 x 980 x 1798	725	250
REX DUAL 50	83804030	250	272	91,91 90,40	2,0	200-250	160	15	220	1793 x 980 x 2048	820	250
REX DUAL 60	83805030	300	325	92,31 90,62	2,0	200-250	180	16	300	1993 x 1080 x 2299	900	250
REX DUAL 70	83806030	350	380	92,11 90,50	2,9	200-250	180	18	356	1993 x 1080 x 2299	1030	250
REX DUAL 80	83807040	400	433	92,38 90,81	4,1	230-280	225	20	360	2244 x 1122 x 2440	1080	250
REX DUAL 10083808040	500	542	92,25 90,71	4,2	270-320	225	22	540	2624 x 1342 x 2490	1600	300	
REX DUAL 12483809040	620	672	92,26 90,68	6,4	270-320	225	27	645	2640 x 1342 x 2792	1800	300	
REX DUAL 15083810070	750	813	92,25 90,60	5,2	270-320	280	25	855	2935 x 1472 x 2756	2280	350	
REX DUAL 17083810080	850	921	92,29 90,73	7,2	270-320	280	27	855	2935 x 1472 x 2756	2280	350	

Working pressure: 5 bar

Fuel: natural gas, gpl, light oil

Minimal return water temperature: 50°C

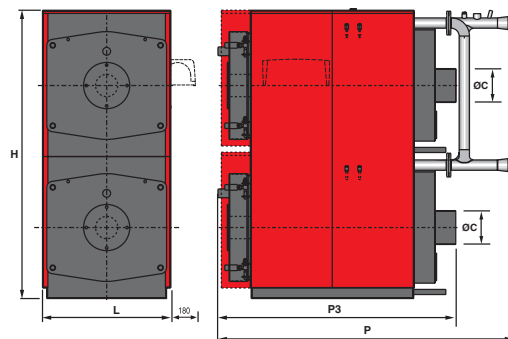

### Standard equipment

- Outer casing with high density insulation
- Turbolators
- Cleaning tool
- Control panel complete with:
  - 2 boiler control/high limit thermostats for the two high/low burners
  - 2 safety limit thermostats
  - 2 burner on/off switches
  - 2 pump thermostats
  - 2 boiler thermometers
  - 1 pump on/off switch
  - 2 hours run meters
- Pipe-work manifold and headers

Optional	Code	For details see
Digital sequencer control panel	31020012	Page 40
Outside probe	17090038	Page 40